



US00D388840S

United States Patent [19]

[11] Patent Number: **Des. 388,840**

Mendelsohn

[45] Date of Patent: ****Jan. 6, 1998**

[54] **SLIDE PUZZLE**

1,989,411	1/1935	Graham et al.	273/153 S
4,732,388	3/1988	Patel	273/153 S
4,927,150	5/1990	Monoyios	273/153 S

[76] Inventor: **Emil-Dan Mendelsohn**, 43-07: 39th Pl., Apt. 1K, Sunnyside, N.Y. 11104

Primary Examiner—Dominic Simone

[**] Term: **14 Years**

[57] **CLAIM**

[21] Appl. No.: **62,560**

The ornamental design for a slide puzzle, as shown and described.

[22] Filed: **Nov. 18, 1996**

DESCRIPTION

[51] LOC (6) CL. **21-01**

[52] U.S. Cl. **D21/104**

[58] Field of Search D21/104; 273/153 R, 273/153 S

FIG. 1 is a front elevational view of the slide puzzle showing my new design;

FIG. 2 is a rear elevational view thereof;

FIG. 3 is a right side elevational view thereof;

FIG. 4 is a left side elevational view thereof;

FIG. 5 is a top plan view thereof;

FIG. 6 is a bottom plan view thereof; and,

FIG. 7 is an isometric view thereof.

[56] References Cited

U.S. PATENT DOCUMENTS

D. 372,745	8/1996	Mruphey	D21/104
961,892	6/1910	Peck	273/153 S
1,539,738	5/1925	Hutton	273/153 S
1,663,568	3/1928	Schneider	273/153 S

1 Claim, 3 Drawing Sheets

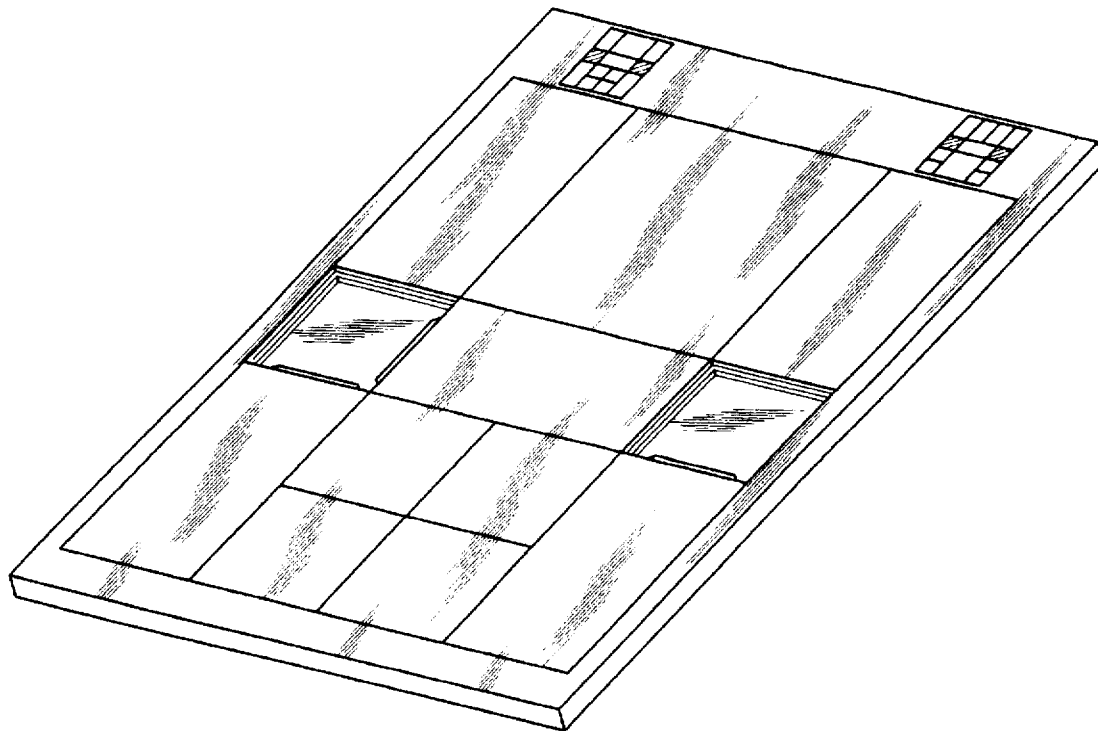

FIG. 1

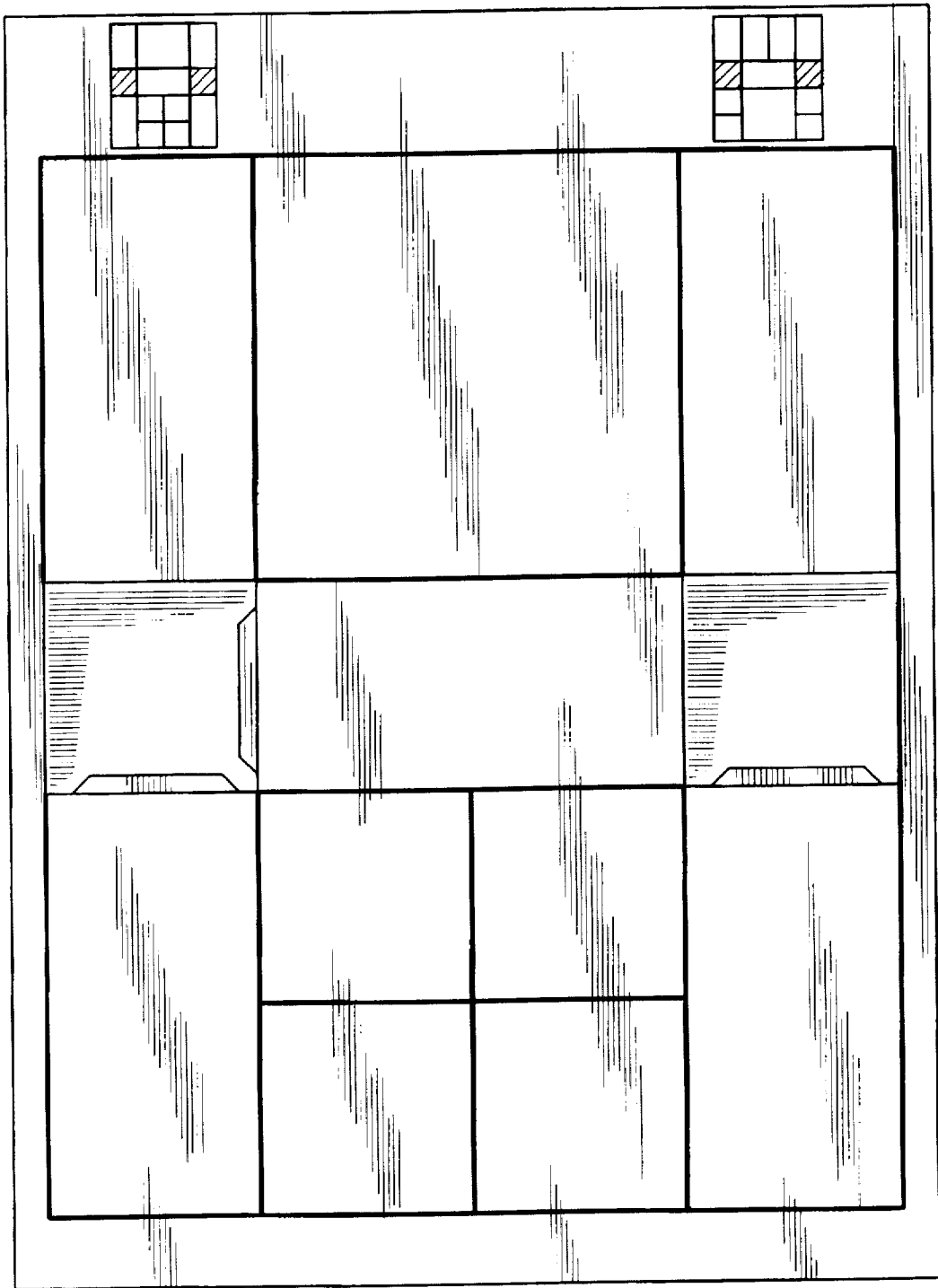

FIG. 2

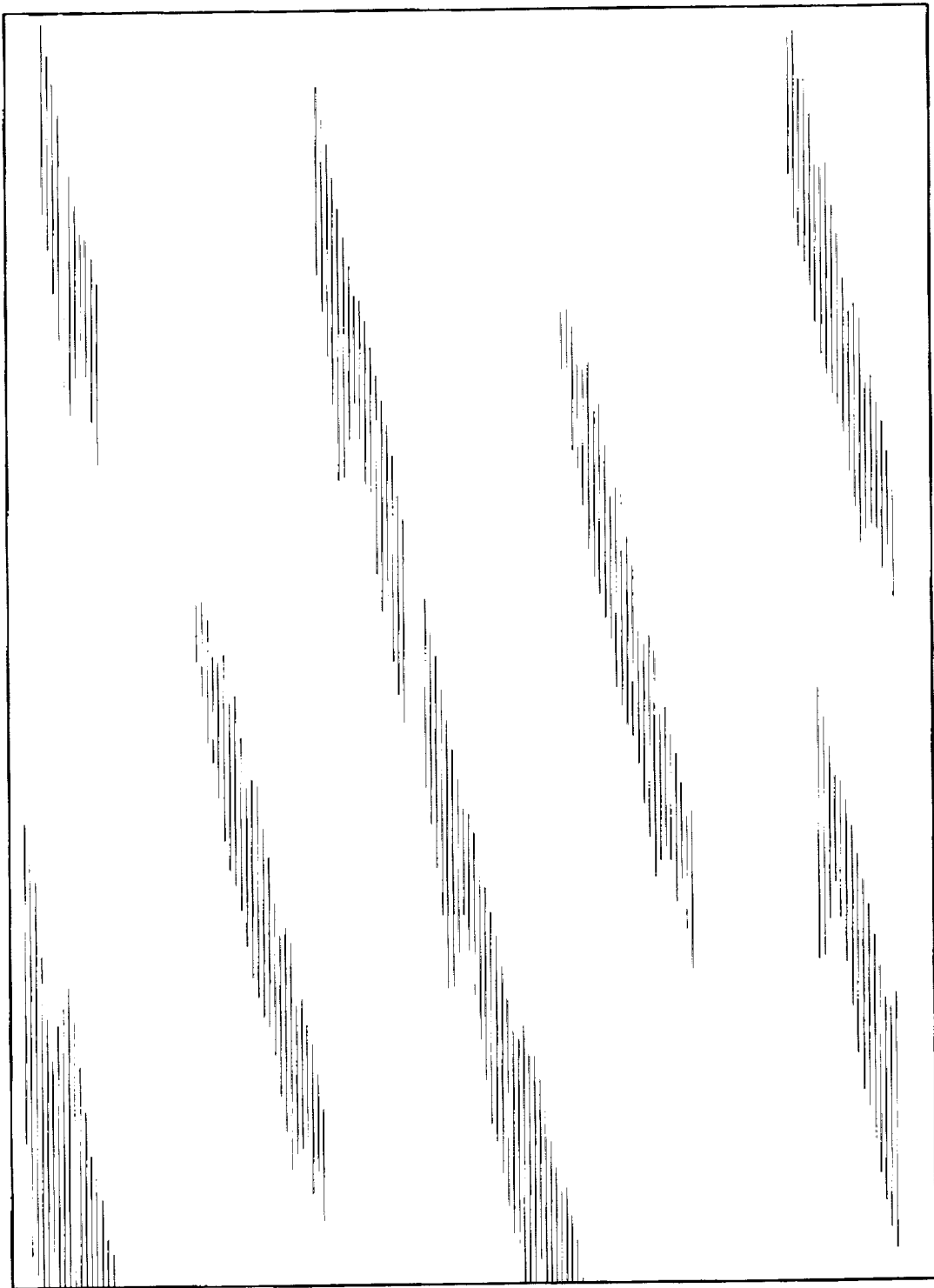

FIG. 3



FIG. 4



FIG. 5

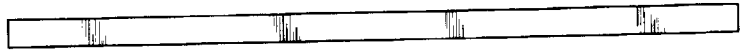

FIG. 6



FIG. 7

